

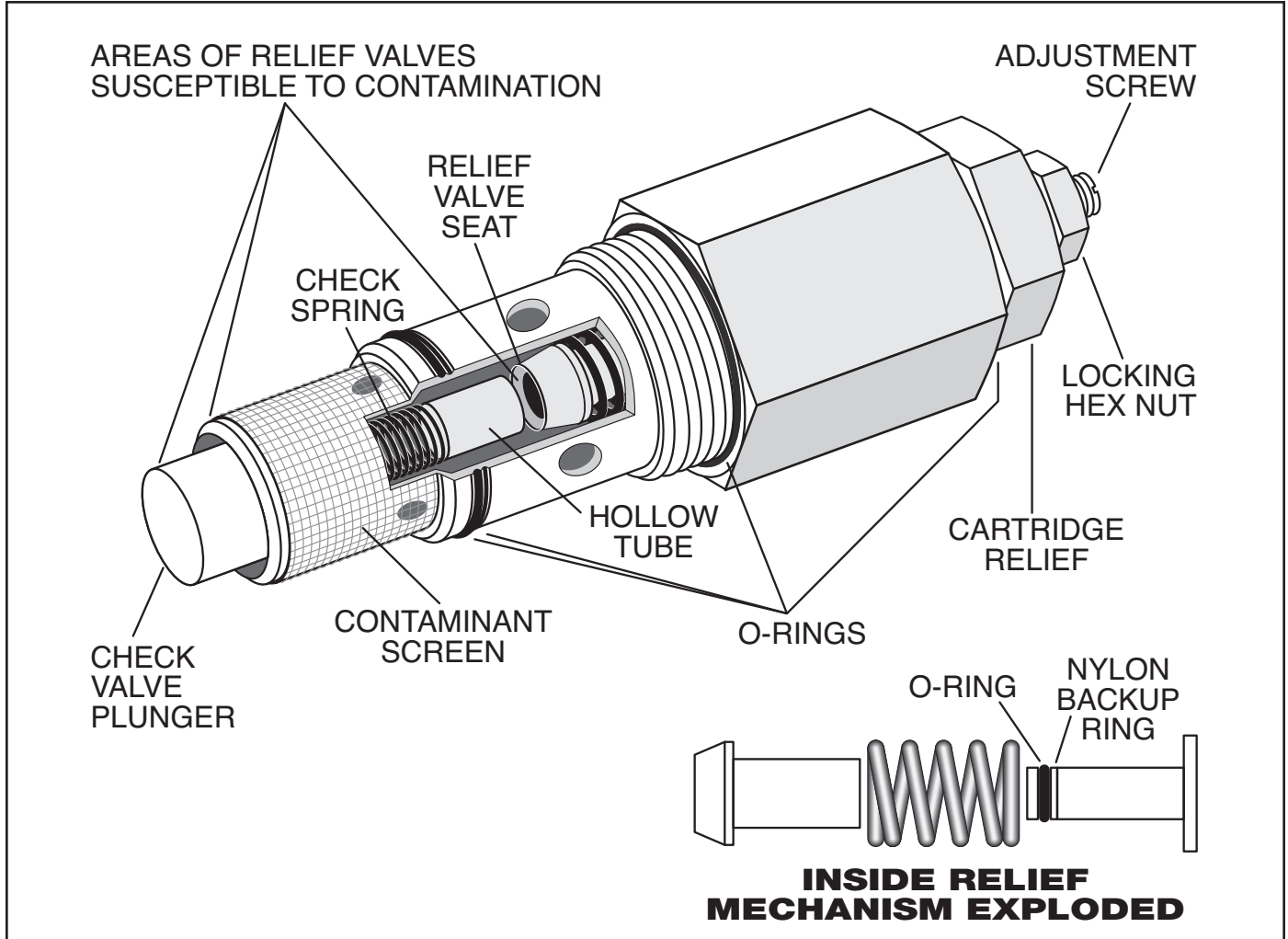

**Muncie[®]
Power
Products**

E/S SERIES DUMP PUMP RELIEF VALVE CARTRIDGE



E Series complete assembly part number: PE-1231V, PE1-1231V **S Series** complete assembly part number: PS-1231V, PS1-1231V

RELIEF VALVE ASSEMBLY

A common complaint which reaches us is that a dump body will not hold in the “up” position, or that it will not lift the load. Usually there is a sliver of metal caught in the area around the check valve plunger or at the relief valve seat.

The best solution usually is to (1) lower the body, (2) shut off the engine, (3) close the shut off valve from the tank (if one exists), and (4) remove the cartridge relief from the pump to inspect it. Once the contaminant is removed, the pump will function satisfactorily...until another contaminant causes a similar condition, *unless* major repairs are necessary.

The check valve plunger should have a smooth sharp edge so that it will seat inside the pump. If any of the surface is scarred, it will affect pump performance. If replacing the O-rings and seals on the E Series relief valve, order part number GSK-E12-RV.

If repairing the S Series relief valve, order part number GSK-S12-RV.



**Muncie[®]
Power
Products**

Muncie Power Products, Inc. Member of the Interpump Hydraulics Group
General Offices and Distribution Center • P.O. Box 548 • Muncie, IN 47308-0548
(765) 284-7721 • FAX (765) 284-6991 • E-mail info@munciepower.com
Web site <http://www.munciepower.com>