

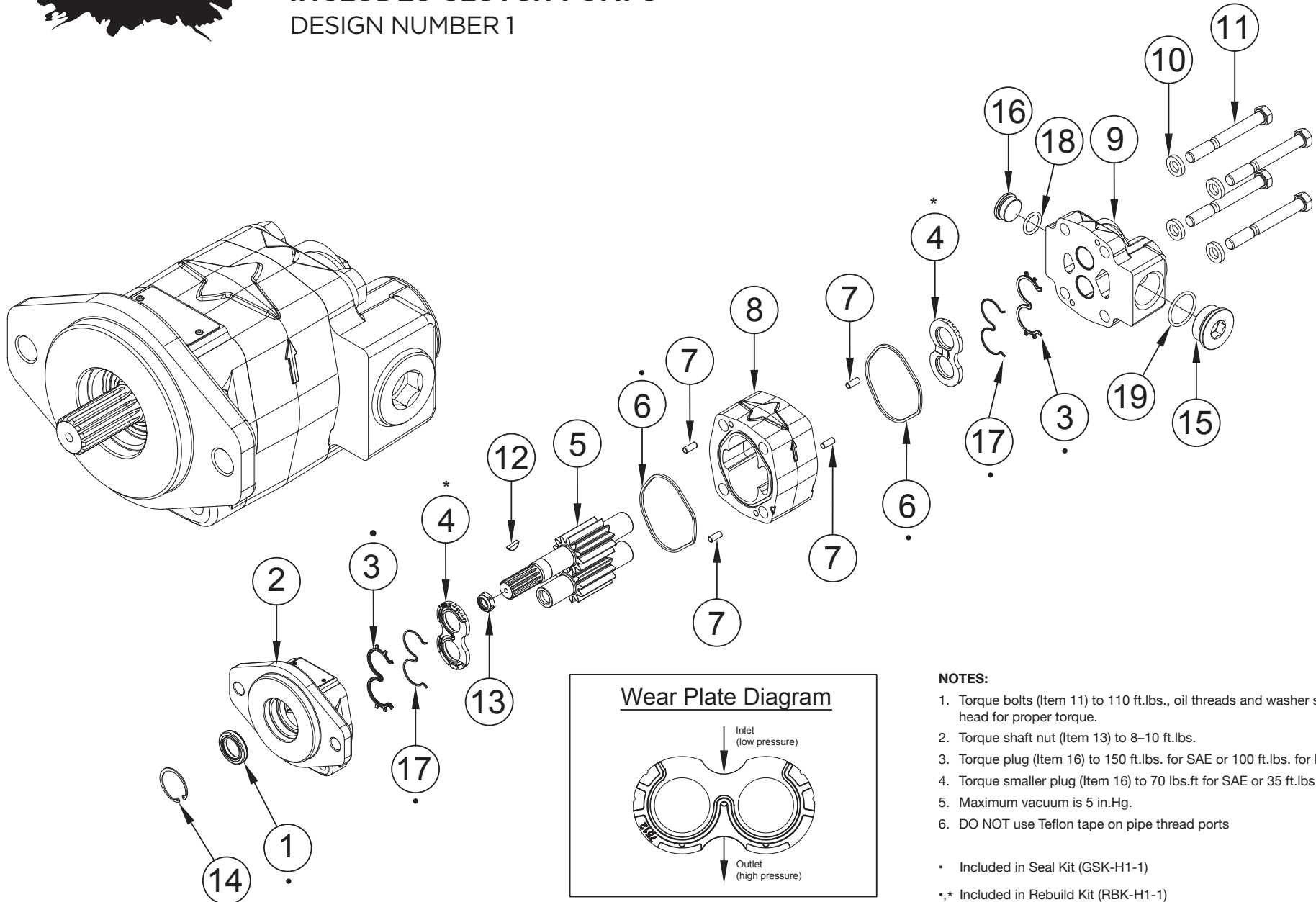

H SERIES SERVICE PARTS

INCLUDES CLUTCH PUMPS

DESIGN NUMBER 1



NOTES:

1. Torque bolts (Item 11) to 110 ft.lbs., oil threads and washer side of head for proper torque.
2. Torque shaft nut (Item 13) to 8-10 ft.lbs.
3. Torque plug (Item 16) to 150 ft.lbs. for SAE or 100 ft.lbs. for NPT
4. Torque smaller plug (Item 16) to 70 lbs.ft for SAE or 35 ft.lbs. for NPT
5. Maximum vacuum is 5 in.Hg.
6. DO NOT use Teflon tape on pipe thread ports

• Included in Seal Kit (GSK-H1-1)

•* Included in Rebuild Kit (RBK-H1-1)

H SERIES PUMP SERVICE PARTS

Item	Description	Qty.	Muncie Number
1	Shaft Seal	1	PH1-1005
2 ^A	Front Cover SAE A Flange	1	PH1-1107-ASXXX
	SAE B Flange	1	PH1-1107-HSXXX
	Remote Pad Mount (Clutch Pump)	1	PH1-1107-RSXXX
NS ^A	Bushings	4	PH1-1013
3	Balance Seal	2	PH1-1008-B
4	Wear Plate	2	PH1-1014
5	Gear Set		
	7/8-13T 3 GPM	1	PH1-1016S02-03-2
	7/8-13T 5 GPM	1	PH1-1016S02-05-2
	7/8-13T 7 GPM	1	PH1-1016S02-07-2
	7/8-13T 8 GPM	1	PH1-1016S02-08-2
	7/8-13T 9 GPM	1	PH1-1016S02-09-2
	7/8-13T 11 GPM	1	PH1-1016S02-11-2
	Tapered Shaft Clutch Pump		
	3 GPM.....	1	PH1-1016T04-03-2
	5 GPM.....	1	PH1-1016T04-05-2
	7 GPM.....	1	PH1-1016T04-07-2
	9 GPM.....	1	PH1-1016T04-09-2
	11 GPM.....	1	PH1-1016T04-11-2
6	Body Seal	2	PH1-1015
7	Dowel Pins	4	PH1-1024
8	Body		
	3 GPM.....	1	PH1-1125-03XX
	5 GPM.....	1	PH1-1125-05XX
	7 GPM.....	1	PH1-1125-07XX
	8 GPM.....	1	PH1-1125-08XX
	9 GPM.....	1	PH1-1125-09XX
	11 GPM.....	1	PH1-1125-11XX
9 ^A	Rear Cover NPT Both Side and Rear Ports	1	PH1-1126-PCP2
	Rear Cover SAE Both Side and Rear Ports	1	PH1-1126-SGR2
10	Lockwasher	4	PH1-1029

NOTE:

A. Covers are shipped with bushings (PH1-1013) installed

Item	Description	Qty.	Muncie Number
11	Cap Screw		
	3 GPM (1/2-13 UNC x 2 3/4)	4	PH1-1028-03
	5 GPM (1/2-13 UNC x 3 1/4)	4	PH1-1028-05
	7 GPM (1/2-13 UNC x 3 1/2)	4	PH1-1028-07
	8 GPM (1/2-13 UNC x 3 3/4)	4	PH1-1028-08
	9 GPM (1/2-13 UNC x 4)	4	PH1-1028-09
	11 GPM (1/2-13 UNC x 4 1/4)	4	PH1-1028-11
12	#6 Woodruff Key (Tapered shaft only)	1	PH1-1017-W
13	Nut (1/2-20 Nylock) (Tapered Shaft Only).....	1	PH1-1020
14	Snap Ring (Tapered Shaft Only)	1	PH1-1004
15	Inlet Port Plug		
	-20 NPTF.....	1	HHPP-20Z
	-20 SAE w/O-Ring	1	HHBP-20Z
16	Outlet Port Plug		
	-12 NPTF.....	1	HHPP-12Z
	-12 SAE w/O-Ring	1	HHBP-12Z
17	Back-Up Seal	2	PH1-1009
18	O-Ring 0.92 x 0.12 (for HHBP-12Z)	1	BOR-12
19	O-Ring 1.50 x 0.12 (for HHBP-20Z)	1	BOR-20
CLUTCH PUMP REPLACEMENT CLUTCHES			
N.S.	6" Fanbelt Clutch (32 HP, 2-Groove "V" Belt).....	1	FBC32-6A
N.S.	6" Fanbelt Clutch (32 HP, 6-Groove Poly Belt).....	1	FBC32-6PA
N.S.	6" Fanbelt Clutch (32 HP, 8-Groove Poly Belt).....	1	FBC32-6P8A
N.S.	Flange Yoke Clutch (70 HP).....	1	FCY-70A
N.S.	Coil (32 HP)	1	RC32-6A
N.S.	Coil (70 HP)	1	RC-70
"H" SERIES KITS			
N.S.	Seal Kit GSK-H1-1 (Includes items 1, 3, 6, and 17)		
N.S.	Rebuild Kit RBK-H1-1 (Includes items 1, 3, 4, 6, and 17)		
"S" EXTENDED STUDS (Replaces 2 of cap screw item 11)*			
N.S.	Stud.....	1	20T66958
	Cut to length to make 2 studs		
	03 - 4.75", 05 - 5.25", 07 - 5.50"		
	08 - 5.75", 09 - 6.00", 11 - 6.25"		
N.S.	Nut.....	4	22T20521

NOTE: * See I-4199 Stud Installation Instructions



A Member of the Interpump Group

SP10-01 (Rev. 11-22)

201 East Jackson Street, Muncie, Indiana 47305
800-367-7867 • Fax: 765-284-6991 • info@munciepower.com

Specifications are subject to change without notice. Visit www.munciepower.com for warranties and literature. All rights reserved. © Muncie Power Products, Inc. (2010)