

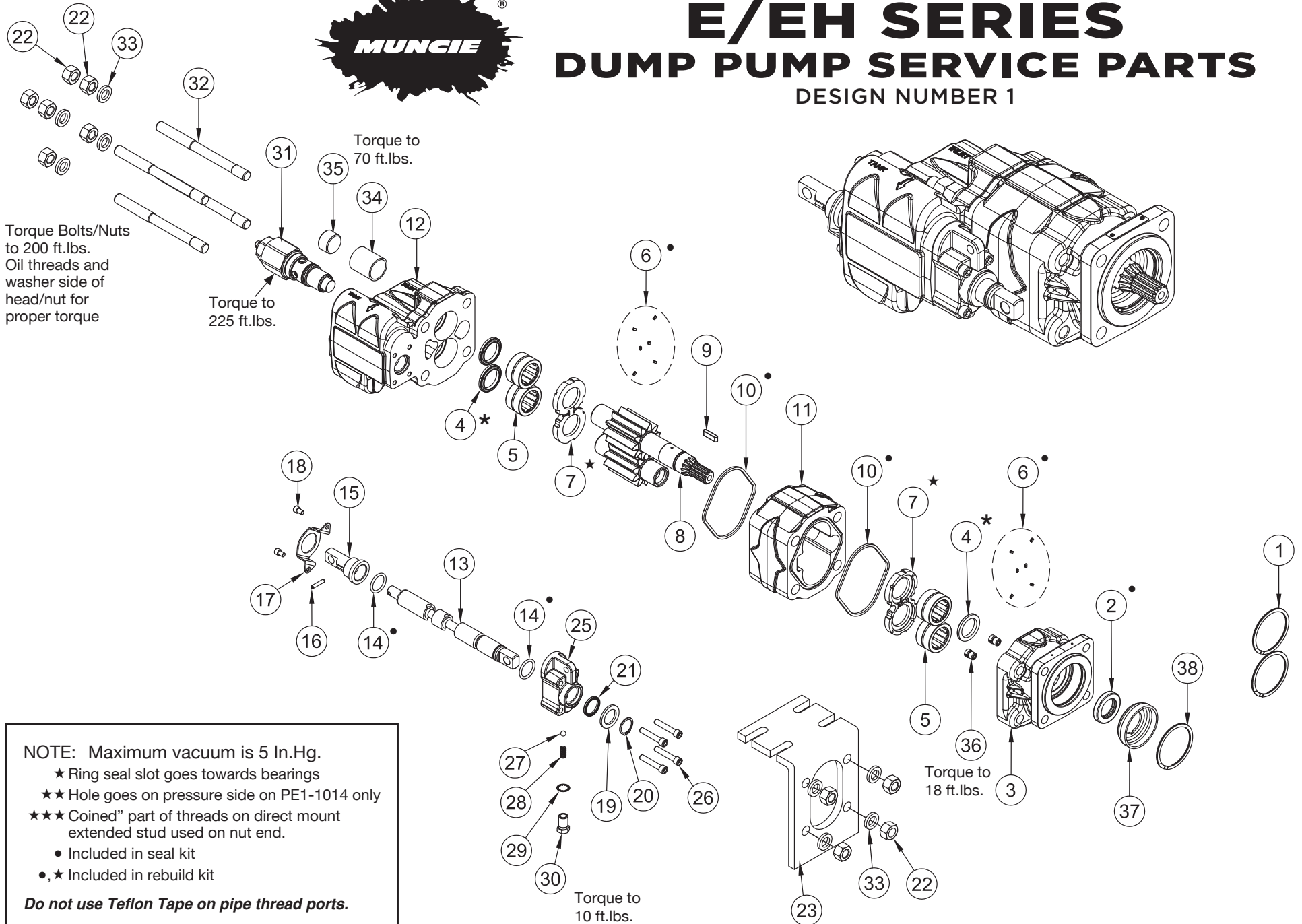

E/EH SERIES DUMP PUMP SERVICE PARTS

DESIGN NUMBER 1



E/EH SERIES DUMP PUMP SERVICE PARTS

Item	Description	Qty	Muncie Number
N.S.	O.B. Snap Ring (wet spline only)	1	PL1-1001
N.S.	Seal Retainer (wet spline only)	1	PL1-1003M
N.S.	O-Ring (wet spline only)	1	PL1-1004M
N.S.	Outside Seal (reversed) (wet spline only)	1	PL1-1005CV
1	Snap Ring Remote Mount	2	PE1-1004
2	Shaft Seal Remote Mount	2	PE1-1005
	Shaft Seal Direct Mount	1	PL1-1005
N.S.	Front Cover Direct Mount (wet spline only)	1	PE1-1007-KLXXX-WS
3	Front Cover Direct Mount	1	PE1-1007-KLXXX
	Front Cover Remote Mount	1	PE1-1007-RSXXX
4	Ring Seal	3	PL1-1008
5	Bearings	4	PL1-1013
6	Pocket Seals (12 pieces)	1	PS1-1009-EK
7	Wear Plates Remote Mount	2	PE1-1014 *
	Wear Plates Direct Mount	2	PL1-1014
8	Gear Set 1 Round 23 GPM Remote Mount	1	PE1-1016-K01-23-2
	Gear Set 1 Round 27 GPM Remote Mount	1	PE1-1016-K01-27-2
	Gear Set 7/8 -13T 23 GPM Direct Mount	1	PE1-1016-S02-23-2
	Gear Set 7/8 -13T 27 GPM Direct Mount	1	PE1-1016-S02-27-2
9	Key Remote Mount (0.25 x 0.375 x 1.25)	2	PS1-1017
10	Body Seal Front Cover	2	PL1-1012
11	Body 23 GPM	1	PE1-1025-23XX
	Body 27 GPM	1	PE1-1025-27XX
12	Rear Cover Direct Mount	1	NA
	Rear Cover Remote Mount	1	NA
13	Valve Spool	1	NA
14	Spool O-Ring	2	PE1-1214-V
15	End Stop Cap	1	PE1-1206-V
16	Stop Pin	1	PS1-1216-V
17	Stop Spool Bracket	1	PE1-1207-V
18	Bracket Screws (1/4-20 UNC x 3/8)	2	PS1-1218-V
19	Retainer Ring	1	PE1-1201-V
20	Snap Ring	1	PE1-1202-V
21	Retainer Wiper Seal Ring	1	PE1-1204-V
22	Nut (5/8-11 UNC)	4 or 6	PE1-1020
23	Remote Mounting Bracket	1	B1235, B1235A
25	Spool Cover	1	PE1-1203-V
26	Spool Cover Screws	4	PE1-1205-V
27	Detent Ball	1	PS1-1227-V
28	Detent Spring	1	PS1-1228-V
29	Detent Lockwasher	1	PS1-1229-V
30	Detent Retainer	1	PE1-1230-V
31	Relief Valve Assembly	1	PE1-1231-V
32	Capscrew 23 GPM (5/8-11 UNC x 7)	4	PE1-1028-23

Item	Description	Qty	Muncie Number
	Capscrew 27 GPM (5/8-11 UNC x 7 1/2)	4	PE1-1028-27
	Stud 23 GPM (5/8-11 UNC x 7)	4	PE1-1028-23-S
	Stud 27 GPM (5/8-11 UNC x 7 1/2)	4	PE1-1028-27-S
33	Washer	4 or 8	PE1-1230
34	Conversion Sleeve E	1	AA-1257
	Conversion Sleeve EH	1	AA-1257-2
35	Pipe Plug (1")	1	HHPP-16Z
36	Check Valve Assembly (direct mount)	2	PS1-1010
37	Retainer/Spacer (direct mount)	1	PE1-1002-D
38	Snap Ring Direct Mount	1	PL1-1001
N.S.	Plug (wet spline only)	1	09900327000

Kits

	Qty	Muncie Number
N.S.	Seal & O-Ring Kit Direct Mount E/EH 23/27 GPM	kit GSK-E-121
	Seal & O-Ring Kit Remote Mount E/EH 23/27 GPM	kit GSK-E-122
	Rebuild Kit Direct Mount E/EH 23/27 GPM	kit RBK-E-121
	Rebuild Kit Remote Mount E/EH 23/27 GPM	kit RBK-E-122
	Bearing Kit	kit PL1-1013-K
	Relief Valve Seal Kit E/EH 23/27 GPM	kit GSK-E-12RV

* Hole in wear plate goes on pressure side.

Gears are only sold in sets and cannot be serviced individually.
Rear cover and valve spool are not sold as service parts.

AIR CYLINDER KIT: ACM302 (Fits both E/EH Series) Ports are 1/8" - 27 NPT

Item	Description	Qty	Muncie Number
1	Piston	Ass'y Only	PE1-1400-AV
2	Quad Seal (PE1-1401-AV)		
3	Spring Retainer		
4	Spring		
5	Wire Ring		
6	Spring Retainer	1	PE1-1402-AV
7	O-Ring	1	PE1-1403-AV
8	Clevis Pin	1	PE1-1404-AV
9	Snap Ring	1	PE1-1405-AV
10	O-Ring	1	PE1-1406-AV
11	Pressure Cap	1	PE1-1407-AV
12	Cap Screw	4	PE1-1408-AV

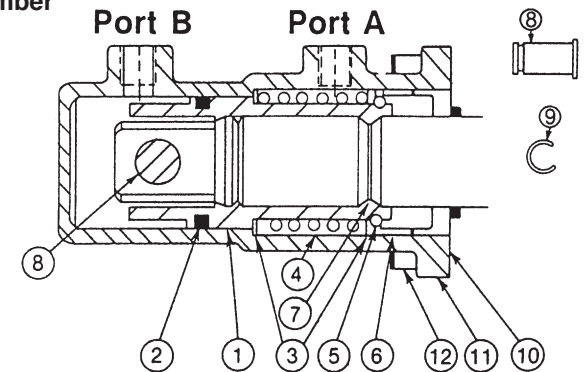

A Member of the Interpump Group

SP08-03 (Rev. 04-21)

201 East Jackson Street, Muncie, Indiana 47305
800-367-7867 • Fax: 765-284-6991 • info@munciepower.com

Specifications are subject to change without notice. Visit www.munciepower.com for warranties and literature. All rights reserved. © Muncie Power Products, Inc. (2008)